

Connector
Part no. 700A



- screw terminals
- with grommet

Technical specifications

Ampere	32 A
Poles	2 p
Voltage	50 V
Clock position	10 h
Connection technology	Screw terminals
Contact	standard
Protection type	IP 44
Weight	186 g
Declaration of Conformity	EAC, CQC

Drawing

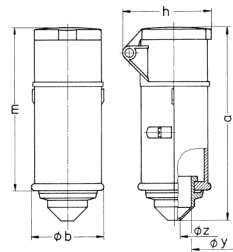

Drawing	Amp.	16		32	
		2	3	2	3
3 MB 37	Poles				
Dim. in mm	a	144	144	144	144
	b	55	55	55	55
	h	67	67	67	67
	m	122	122	122	122
	y	25	25	25	25
	z	9	9	9	9
Terminal for cond. cross		4	4	4	4
section (mm ²) min.-max.		—10	—10	—10	—10