

**Cepex masking frames**  
Part no. 41423



- single
- matching all Cepex flush mounted and panel mounted 16 A and 32 A receptacles, for the installation of single appliances and for vertical combination of any number of receptacles

**Technical specifications**

Weight	20 g
Declaration of Conformity	EAC

**Drawing**

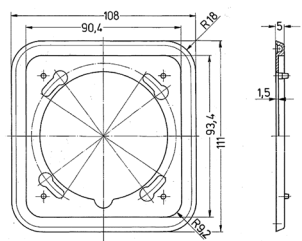

Drawing  
1 MB 363  
Dim. in mm