

Cepex masking frames
Part no. 41407



- single
- matching all Cepex flush mounted and panel mounted 16 A and 32 A receptacles, for the installation of single appliances and for vertical combination of any number of receptacles

Technical specifications

Weight	20 g
Declaration of Conformity	EAC

Drawing

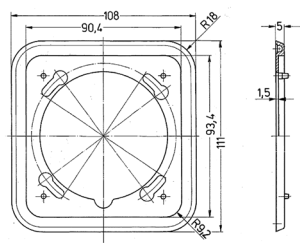

Drawing
1 MB 363
Dim. in mm